

InnoVfoam B.V.

Low expansion Foam Branchpipe

TYPE: FIXED

DRAWING

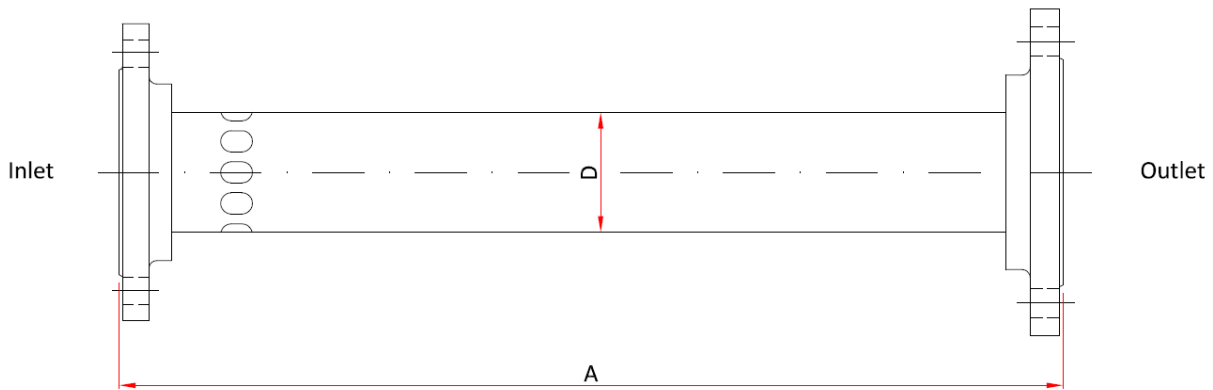

PERFORMANCE

MODEL	CAPACITY [L/min]	A [mm]	INLET CONN.	øD [mm]	OUTLET CONN.	WEIGHT [kg]~
LFFB-200	200	580	2" or DN50	2"	3" or DN80	12
LFFB-400	400	580	2" or DN50	2"	4" or DN100	12
LFFB-600	600	580	3" or DN80	3"	4" or DN100	18
LFFB-800	800	580	3" or DN80	3"	4" or DN100	18
LFFB-1000	1.000	1.000	3" or DN80	3"	4" or DN100	18
LFFB-1200	1.200	1.000	4" or DN100	4"	6" or DN150	33
LFFB-2000	2.000	1.000	4" or DN100	4"	8" or DN200	33

Working pressure 5 bar

Please specify flow, inlet pressure and in/outlet connection AISI or DIN when ordering.

MATERIALS

Body : Carbon steel ASTM A106 Gr. B

Flanges : Carbon steel ASTM A105

Nozzle : AISI 304

InnoVfoam B.V.

Low expansion Foam Branchpipe

TYPE: PORTABLE

DRAWING

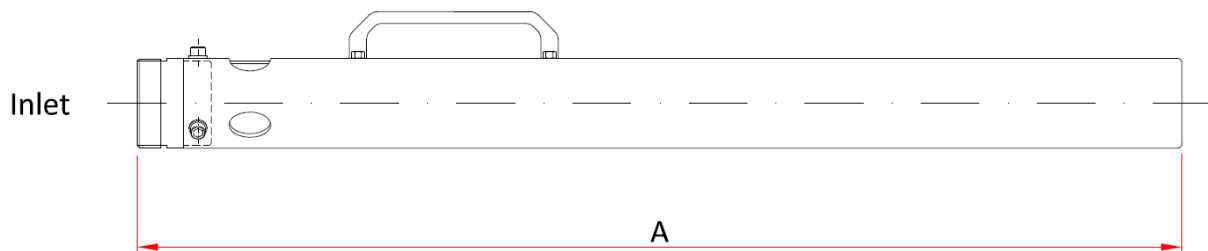

PERFORMANCE

MODEL	CAPACITY [L/min]	INLET CONN.	A [mm]	WEIGHT [kg]~
LPFB-200	200	2" BSPM	900	5
LPFB-400	400	2" BSPM	900	5
LPFB-500	500	2" BSPM	900	5
LPFB-800	800	2,5" BSPM	900	5

Working pressure 5 bar

Expansion ratio approx. 1:6 to 1:15 (depending on foam concentrate type)

Please specify flow, inlet pressure and inlet connection (other than threaded is possible) when ordering.

MATERIALS

Body : AISI 304 (AISI 316 optional)

Nozzle : Brass

Handle : Plastic

STANDARD PAINTING PROCEDURE

Chemical washing

Epoxy primer

Polyuretanic enamel RAL3000 total thickness 100 µm